



June 2021

Hello SCAN members!

The now-annual trek to the Francis Marion National Forest over Memorial Day weekend was another great success! Campers and day-trippers found plenty of places to explore across Berkeley and Charleston Counties. We concentrated our efforts on Washo Reserve on Saturday. The weather was nice and hot on Friday and Saturday, with sunny skies and highs in the 90ies. Rain moved in Saturday night and cooled everything down to the low 80ies for Sunday and Monday.



Washo Reserve attendees included:

Alison Smith	Hal Giles	Kim McManus	Sharleen Johnson
Cynthia Giles	Jerry Bright	Lee Morris	Sharon Watson
Dave Schuetrum	Joe Long	Marcus Sizemore	
Fred Martin	Kathy Boyle	Michael Crawford	

FMNF explorers also included:

Eddie Hade	Jeff Holmes	Paul Kalbach	Tess Moody
Greg Ross	Mandy Johnson	Sharon Johnson	Ty Hade
Ian Deery	Parker Gibbons	Stephen Crotts	
Jackie Holmes	Patrick Hade	Stephen Prior	

Throughout the weekend, groups traveled the dirt roads of the Francis Marion National Forest, looking for snakes, toads, turtles, birds, and anything else that caught their fancy. Highlights included finding a beautiful Corn Snake, two Pygmy Rattlesnakes, a crayfish, and lots of Yellow-crowned Night Herons. The Blue Flag Irises were blooming. Thistle plants ranged from budding to fully blooming to almost done, depending on which road we explored. Prothonotary Warblers and Northern Parulas competed for our attention. The Chuck Will's Widows held nightly singing contests to the amusement and frustration of the tent campers.





*L to R: Prothonotary Warbler, Pygmy Rattlesnake, Eastern Tiger Swallowtail*



*L to R: exploring Hell Hole Road; Paul Kalbach, Lee Morris and Michael Crawford documenting a turtle; White-tailed Deer*

On Saturday, we explored Washo Preserve in the Santee Coastal Reserve mostly on foot, with a few folks taking advantage of the vehicle-accessible roads. The group started by exploring the 800-foot boardwalk. It wound through a cypress swamp and terminated at a 200-year-old cypress pond. There wasn't much bird activity in this area, but we saw plenty of Northern Cottonmouths!

After the boardwalk exploration, the group spread out a bit more, with people choosing one of the many numerous trails through other parts of the Reserves. Habitats included old rice field impoundments, cypress swamps, and pine forests. The only mar on the day was the persistence of the deer flies, which plagued everyone.



*L to R: coneflower, boardwalk, Northern Cottonmouth*



*L to R: Delta Flower Scarab, Cypress Swamp, Great Blue Skimmer*

Thanks to Marcus Sizemore for scouting Washo Reserve and providing guidance on the best places to explore.

Our June trek takes us to Ninety Six National Historic Site in the Western Region. The name of the park reflects the unusual name 1700s Charleston traders bestowed on the area because it was roughly the number of miles from that location to the Cherokee village of Keowee in the upper South Carolina foothills. Ninety Six was the site of two significant Revolutionary War battles and features Star Fort, a well-preserved earthen structure that exemplifies 18<sup>th</sup> century fortification.

Lee Morris has not only scouted the area but coordinated with the park rangers to ensure we have enough parking for our potentially large group. In addition to the Star Fort and several other historical features, the park contains several types of forest, open fields, a small lake, and wetlands. Read on to learn more about what to expect during our outing on Saturday, June 26.

One more item in preparation for July's trip, consider installing the free Avenza app. Phillip Harpootlian has provided a trail map of Nine Times Preserve that can be downloaded and referenced during our visit next month. Once you've installed the Avenza app, follow these steps: download the attached pdf to your phone, open Avenza and click the Plus button, select Download or import a map, and choose From Storage Locations. This will put the map in your app. Of course, you can also give Avenza a try this month by downloading the free Ninety Six USGS Topo from within the app.

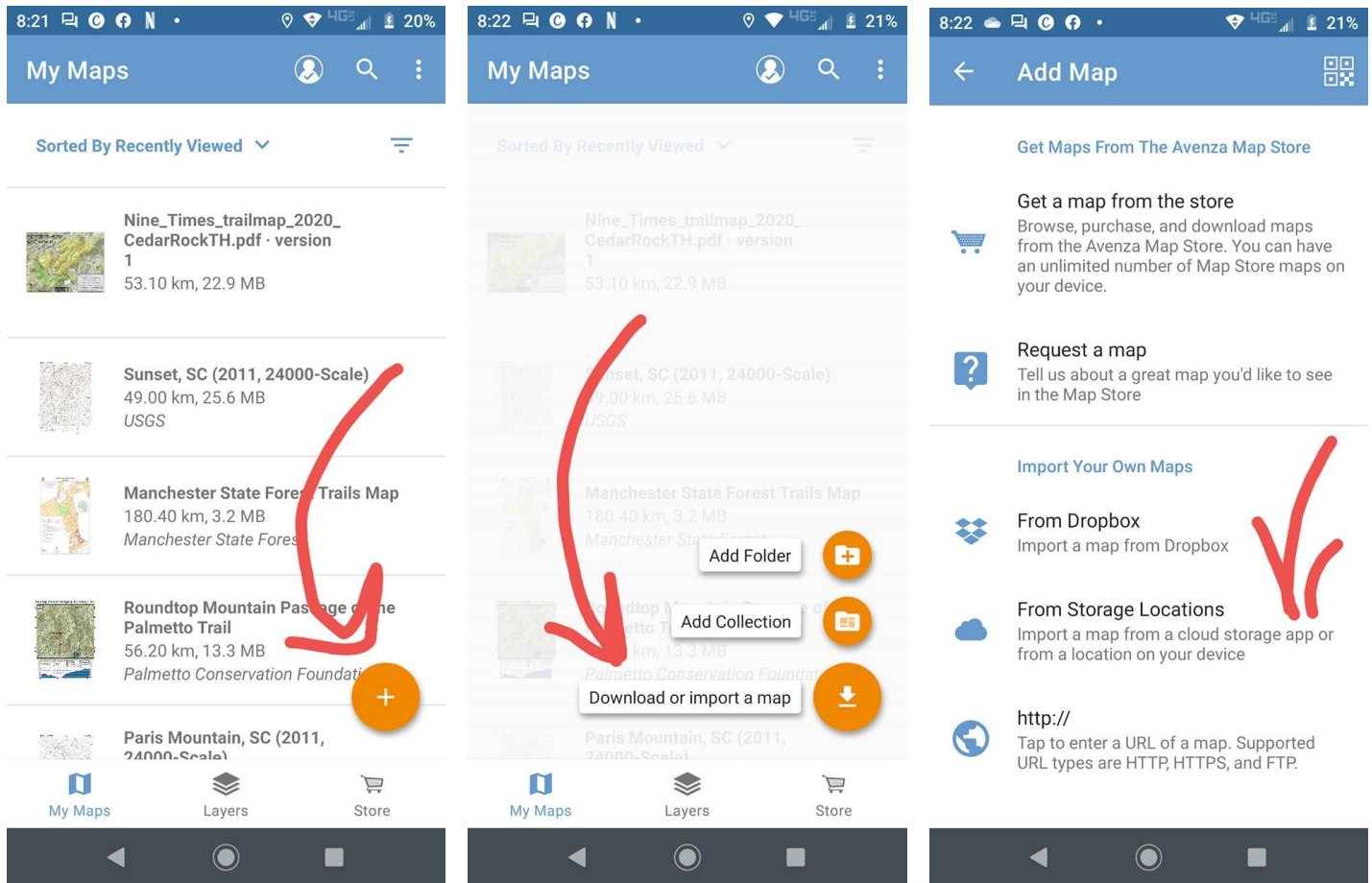

We hope you'll join us!

Kim McManus

**Ninety Six National Historic Site**  
**Greenwood County**  
**June 26, 2021**

Western Regional Director: Lee Morris

For the June trip, we will be visiting Ninety Six National Historic Site in Greenwood County. The history of the site reaches back decades before the Revolutionary War and is the site of the first Southern land battle in that war in 1775 (the locals were Loyalists). The site is renowned for the remains of a small, star-shaped fort. This site is located two miles south of SC 34 in the town of Ninety Six. There is a Visitor's Center which is currently not open due to COVID-19 restrictions, although there will likely be some rangers on site. The restrooms opposite of the Visitor's Center are open; see COVID-19 restrictions below.

The site encompasses 1022 acres of continuous property and has a number of diverse habitats, including bottomland hardwood forest, mesic-mixed hardwood forest, mowed and un-mowed fields, creeks, and a small lake with an associated wetland. These habitats are well mixed, providing a number of edge communities to thrive. The site is home to a wide variety of flora and fauna (see below). Binoculars are encouraged as there are open fields where birds can be spotted at a distance.

**Trails:**

Interpretive signs, which mainly cover the site's history, dot the site on the **Historical/Walking Tour Trail**, which is paved (1 mile). This trail also has occasional benches. It wanders behind the visitor's center and eventually into the battlefield to Star Fort, through the historic Town of Ninety Six Site, to the Stockade Fort, and ends up at the parking lot after passing the Logan Log House. This is a loop trail.

The **Cherokee Path Trail** (blue blazes, 1.5 miles) starts off the Historical Trail as a partially mowed path across a field and then wanders into the forest as a typical hiking trail (not paved). It leads to Star Fort Pond on the eastern part of the site. This is NOT a loop trail. This trail is purportedly in the area of the historical Old Cherokee Path which ran from the coast to the Cherokee town of Keowee (near Clemson).

The **Gouedy Trail** (1.5 miles) is not paved, but is also used as an access road. It branches off of the Historical Trail and will loop around. This trail has historical significance and wanders through a number of habitats. The Gouedy Trail crosses the Cherokee Path trail; combinations of the Historical, Cherokee Path, and Gouedy trails can provide a good survey of the site and alternate paths for different SCAN groups.

The **Fisherman's Trail** (yellow blazes) rings around Star Fort Pond on the eastern part of the property. It can be accessed by the Cherokee Path Trail from the Visitor's Center (which is on the western side), but can also be accessed by a separate parking lot from the eastern side on Kinard Road. It is not paved and wanders through both grassy areas and forest. The southern part of the pond often has people fishing from the banks. The forested area is in the northern part of the pond area; wading birds and other waterfowl are often found here. Currently there are a number of barn swallows buzzing the pond; there is at least one barn swallow nest under the floating dock. Fishing is allowed at Star Fort Pond provided the fisherperson has a valid fishing license.

There are equestrian trails on the property; I do not know the current condition of these trails. National Park brochures of the site can be found at a kiosk in the area of the Visitor's Center. These have small trail maps and descriptions of some of the history of the site.

There picnic tables on the Historical Trail between the Logan Log House and the Stockade Fort. We do NOT have a reservation for these so we will not be meeting for lunch as a large group; they are first come, first serve, so our small groups shouldn't be a problem using them. There is a shelter on the western side of Star Fort Pond (opposite the Pond parking lot) and there are various benches throughout some trails.



A few biodiversity studies have been completed in the park, generally about 15 years ago. Some numbers: 366 species of plants, 22 species of fish (3 species of concern), 31 species of herpetofauna, 137 species of birds (31 are species of concern), 18 species of mammals. Special survey in 2007 studying bats; four species of bats have been found, also some evidence for two other species found. Invertebrate surveys are not published on the website, so I do not know if any have been completed. SCAN members are encouraged to post their observations on iNaturalist or other citizen science websites, but a copy of your species list should also be emailed to Tom Jones.

The Ninety Six National Historical Site's official website is full of information of both the historical and natural history of the site. I strongly urge you to surf the site, especially if you are interested in the historical aspects of the site. <https://www.nps.gov/nisi/index.htm>

We will be parking in the main parking lot near the Visitor's Center at the main entrance of the park on Hwy 248 (S. Cambridge St). There are 28 spaces, both inside and outside the gate. The gate is closed at 4:30pm, but if you are parked inside, it will automatically open. Since this park will also be open to the public, non-SCAN people will be parking as well; if we have large numbers, some of us may be asked to park in the bus parking lot (immediately next to the public parking lot). We will meet in the parking lot; there are a number of large spaces where we will have our intros.

The Superintendent of the Park asks that we follow the CDC guidelines in terms of COVID-19 safety. This really affects only unvaccinated individuals, who are asked to observe social distancing in general and to wear masks inside buildings (in this case, the bathrooms).

It might be useful to bring bug spray; I have heard rumors of a tick-heavy summer.

There is no organized dinner for this trip, but there are a number of restaurants and pubs in the nearby city of Greenwood if anyone wants to stop for dinner.

Ninety Six National Historic Site  
1103 Hwy 248  
Ninety Six, SC 29666

Directions: As this is a National Park Site, there are a number of signs that can direct you from I-26.

From Charleston area:

Take I-26 west to exit 74 (the second Newberry exit), SC 34. Turn left at the light onto SC 34 south. About two miles will bring you to a major crossroad, route 76/SC 34. Turn left and proceed about 1 mile. Turn right (SC 34 turns) and follow SC 34 signs. SC 34 continues about 2.8 miles, then turns right. SC 34 continues for 21 miles into the town of Ninety Six. Turn left on Hwy 248. The Park is 2 miles (south) on the left.

From the Greenville/Spartanburg area:

Take I-26 east to exit 74 (the second Newberry exit), SC 34. Turn right at the light onto SC 34 south. About two miles will bring you to a major crossroad, route 76/SC 34. Turn left and proceed about 1 mile. Turn right (SC 34 turns) and follow SC 34 signs. SC 34 continues about 2.8 miles, then turns right. SC 34 continues for 21 miles into the town of Ninety Six. Turn left on Hwy 248. The Park is 2 miles (south) on the left.

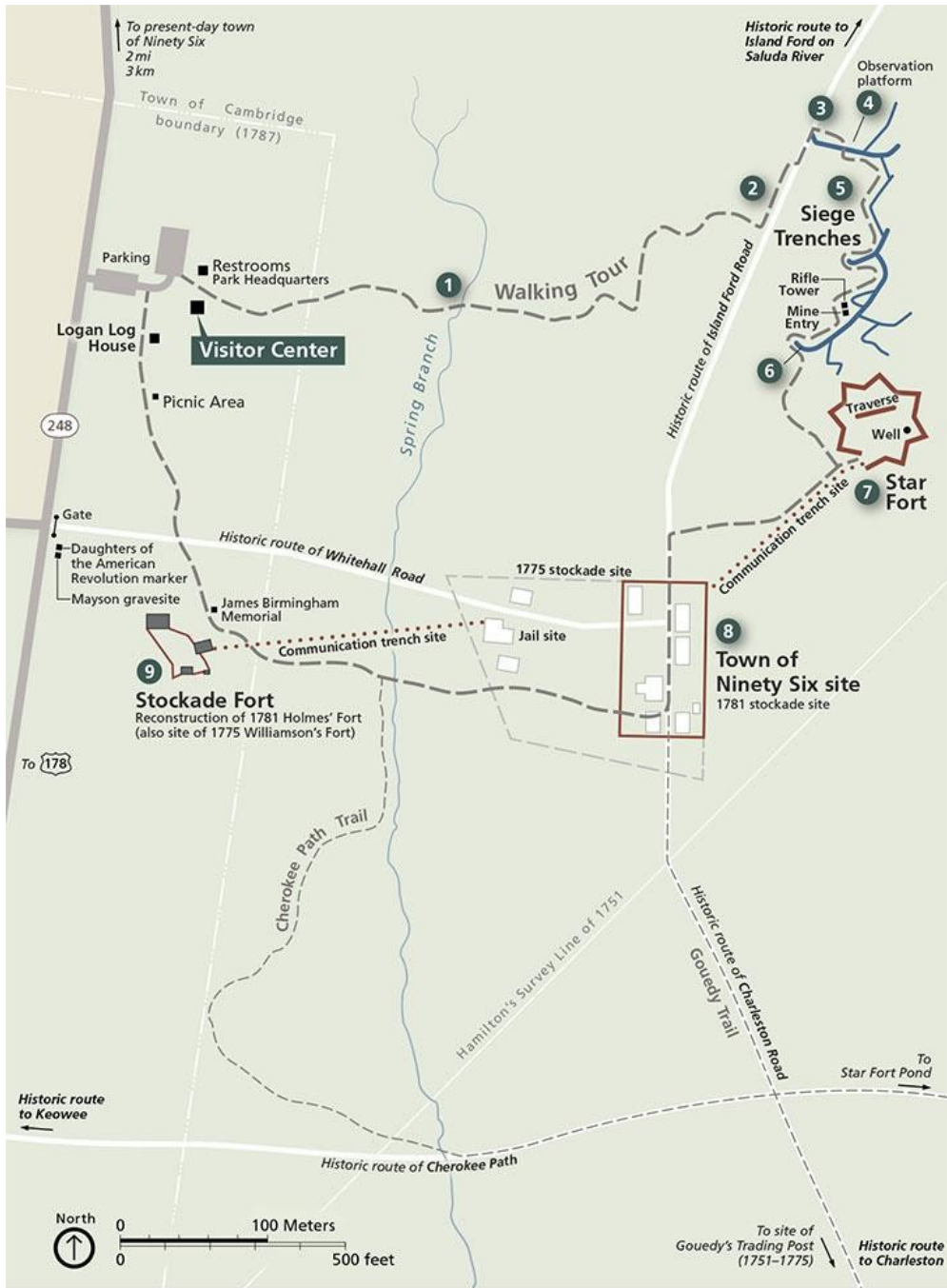

1 Tour stop

Walking tour trail (paved)

Patriot siege trenches

Historic structure site

Other trail (unpaved)

Loyalist fortifications

Some historic structures are marked on the ground with colored posts.

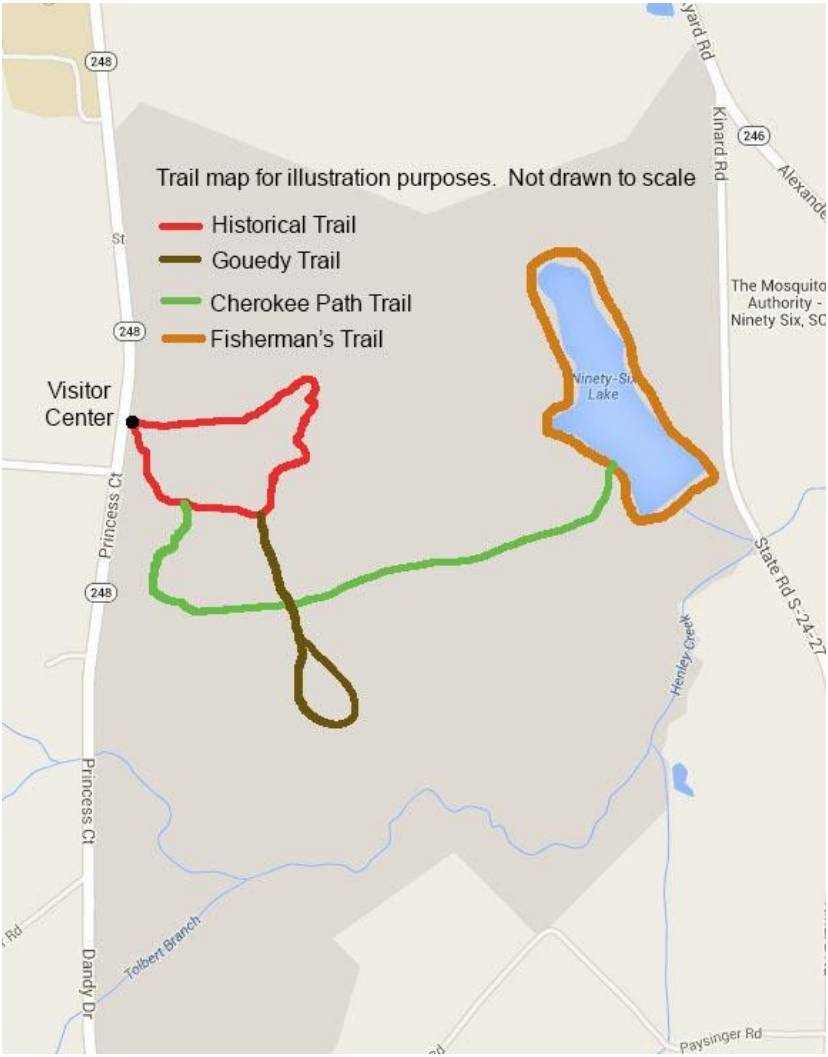

**Hell Hole, Francis Marion Nat. Forest**  
**Berkeley Co., SC**  
**May 29, 2021**

This list was produced by SCAN from sightings produced by SCAN members and is subject to revision as needed. An asterisk (\*) indicates a new sighting for SCAN. Send any changes or corrections to Tom Jones. \_\_\_\_\_

Please indicate exactly to which flora/fauna list you are referring. Thank you.

**FLORA**

**American Royal Fern**  
*Osmunda spectabilis*

**Japanese Climbing Fern**  
*Lygodium japonicum*

**Southern Bracken**  
*Pteridium pseudocaudatum*

**Pond-cypress**  
*Taxodium ascendens*

**White Water-lily**  
*Nymphaea odorata odorata*

**Lizard's-tail**  
*Saururus cernuus*

**Sweetbay**  
*Magnolia virginiana*

**Arrowhead**  
*Sagittaria lancifolia media*

**Northern White Colic-root**  
*Aletris farinosa*

**Common Wild Yam**  
*Dioscorea villosa*

**Common Grass-pink**  
*Calopogon tuberosus tuberosus*

**Spring Ladies'-tresses**  
*Spiranthes vernalis*

**Large Spreading Pogonia**  
*Cleistesiospis divaricata*

**Savanna Iris**  
*Iris tridentata*

**Southern Blue Flag**  
*Iris virginica*

**Pickerelweed**  
*Pontederia cordata*

**Common Cattail**  
*Typha latifolia*

**Common Rush**  
*Juncus effusus solutus*

**Large-headed Rush**  
\* *Juncus megacephalus*

**Bottlebrush Sedge**  
*Carex comosa*

**Walter's Sedge**  
*Carex striata*

**Sawgrass**  
*Cladium jamaicense*

**Squarestem Spikerush**  
*Eleocharis quadrangulata*

**Beaksedge**  
*Rhynchospora* sp.

**Low Rattlebox**  
*Crotalaria rotundifolia*

**Sericea Lespedeza**  
*Lespedeza cuneata*

**Sprawling Hoarypea**  
*Tephrosia hispida*

**Virginia Goat's-rue**  
*Tephrosia virginiana*

**Orange Milkwort**  
*Polygala lutea*

**Swamp Rose**  
*Rosa palustris*

**Black Raspberry**  
*Rubus occidentalis*

**Peelbark St.-John's-wort**  
*Hypericum fasciculatum*

**Passionflower**  
*Passiflora incarnata*

**Queen's-delight**  
*Stillingia sylvatica*

**Water Sundew**  
*Drosera intermedia*

**Carolina Phlox**  
*Phlox carolina*

**Yellow Pitcherplant**  
*Sarracenia flava*

**Hooded Pitcherplant**  
*Sarracenia minor minor*

**Ti-ti**  
*Cyrilla racemiflora*

**Indian-hemp**  
*Apocynum cannabinum*

**Few-flower Milkweed**  
*Asclepias lanceolata*

**Butterfly-weed**  
*Asclepias tuberosa*

**Common Dawnflower**  
*Stylisma patens*

**Blue Water-hyssop**  
*Bacopa caroliniana*

**Southern Beardtongue**  
*Penstemon australis*

**Carolina Wild-petunia**  
*Ruellia caroliniensis*

**Purple Bladderwort**  
*Utricularia purpurea*

**Cluster Bushmint**  
*Hyptis alata alata*

**Self-heal**  
*Prunella vulgaris*

**Mountain-mint**  
*Pycnanthemum* sp.

**Narrowleaf Skullcap**  
*Scutellaria integrifolia*

**Savanna Bluehearts**  
*Buchnera floridana*

**Nuttall's Lobelia**  
*Lobelia nuttallii*

**Common Yellow Thistle**  
*Cirsium horridulum horridulum*

**Mistflower**  
*Conoclinium coelestinum*

**Calliopsis**  
*Coreopsis tinctoria tinctoria*

**Rose Fleabane**  
*Pluchea baccharis*

**Stinking Fleabane**  
*Pluchea foetida foetida*

**Blackroot**  
*Pterocaulon pycnostachyum*

**Black-eyed Susan**  
*Rudbeckia hirta*

**Centella**  
*Centella erecta*

**Eastern Bishopweed**  
*Ptilimnium capillaceum*

**FAUNA**

**Rosy Wolfsnail**  
*Euglandina rosea*

**Pillbug**  
*Armadillidium* sp.

**Crayfish**  
\* *Procambarus* sp.

**Spirobold Millipede**  
*Narceus americanus*

**Writing Spider**  
*Argiope* sp.

**Arabesque Orbweaver**  
*Neoscona arabesca*

**Orchard Orbweaver**  
*Leucauge venusta*

**Golden Silk Orbweaver**  
*Trichonephila clavipes*

**Carolina Wolf Spider**  
*Hogna carolinensis*

**Rabid Wolf Spider**  
*Rabidosa rabida*

**American Green Crab Spider**  
\* *Misumessus oblongus*

**Eastern Harvestman**  
\* *Leiobunum vittatum*

**Lone Star Tick**  
*Amblyomma americanum*

**Mischievous Bird Grasshopper**  
*Schistocerca damnifica*

**Fork-tailed Bush Katydid**  
*Scudderia furcata*

**Meadow Katydid**  
*Conocephalus* sp.



**Leaf-footed Bug**  
*Leptoglossus phyllopus*

**Eastern Toe-biter**  
\* *Benacus griseus*

**Cixiid Planthopper**  
\* *Melanoliarus* sp.

**Red-banded Leafhopper**  
*Graphocephala coccinea*

**Carpenter-mimic Leafcutter**  
*Megachile xylocopoides*

**Brown-belted Bumblebee**  
*Bombus griseocollis*

**Swamp Darner**  
*Epiaeschna heros*

**Gray-green Clubtail**  
*Arigomphus pallidus*

**Halloween Pennant**  
*Celithemis eponina*

**Eastern Pondhawk**  
*Erythemis simplicicollis*

**Bar-winged Skimmer**  
*Libellula axilena*

**Painted Skimmer**  
*Libellula semifasciata*

**Great Blue Skimmer**  
*Libellula vibrans*

**Blue Dasher**  
*Pachydiplax longipennis*

**Citrine Forktail**  
*Ischnura hastata*

**Fiery Searcher; Ground Beetle**  
*Calosoma scrutator*

**Bombadier Beetle**  
*Brachinus* sp.

**Scarab Beetle**  
*Deltochilum gibbosum gibbosum*

**Flower Scarab Beetle**  
*Trichiotinus* sp.

**Bark-gnawing Beetle**  
*Temnoscheila* sp.

**Twice-stabbed Lady Beetle**  
*Chilocorus stigma*

**Blister Beetle**  
*Epicauta vittata*

**Cottonwood Leaf Beetle**  
*Chrysomela scripta*

**Flea Beetle**  
\* *Kuschelina gibbitarsa*

**Pipevine Swallowtail**  
*Battus philenor*

**Eastern Tiger Swallowtail**  
*Pterourus glaucus*

**Palamedes Swallowtail**  
*Pterourus palamedes*

**Pearl Crescent**  
*Phyciodes tharos*

**Common Buckeye**  
*Junonia coenia*

**Viceroy**  
*Limenitis archippus*

**Monarch**  
*Danaus plexippus*

**Southern Pearly-eye**  
*Lethe portlandia*

**Creole Pearly-eye**  
*Lethe creola*

**Appalachian Brown**  
*Lethe appalachia*

**Delaware Skipper**  
*Anatrytone logan*

**Dion Skipper**  
*Euphyes dion*

**Dun Skipper**  
*Euphyes vestris*

**Lace-winged Roadside Skipper**  
*Amblyscirtes aesculapius*

**Pug Moth**  
*Eupithecia* sp.

**Forest Tent Caterpillar**  
*Malacosoma disstria*

**Hummingbird Clearwing Moth**  
*Hemaris thysbe*

**Delicate Cycnia Moth**  
\* *Cycnia tenera*

**Giant Leopard Moth**  
*Hypercompe scribonia*

**Southern Toad**  
*Anaxyrus terrestris*

**Eastern Narrow-mouthed Toad**  
*Gastrophryne carolinensis*

**Yellow-bellied Slider**  
*Trachemys scripta*

**Eastern Mud Turtle**  
*Kinosternon subrubrum*

**Eastern Musk Turtle**  
*Sternotherus odoratus*

**Green Anole**  
*Anolis carolinensis*

**Eastern Glass Lizard**  
*Ophisaurus ventralis*

**Corn Snake**  
*Pantherophis guttata*

**Eastern Kingsnake**  
*Lampropeltis getula*

**Plain-bellied Water Snake**  
*Nerodia erythrogaster*

**Banded Water Snake**  
*Nerodia fasciata*

**Brown Water Snake**  
*Nerodia taxispilota*

**Rough Green Snake**  
*Opheodrys aestivus*

**Copperhead**  
*Agkistrodon contortrix*

**Cottonmouth**  
*Agkistrodon piscivorus*

**Carolina Pigmy Rattlesnake**  
*Sistrurus miliarius miliarius*

**Yellow-crowned Night-Heron**  
*Nyctanassa violacea*

**Great Blue Heron**  
*Ardea herodias*

**Great Egret**  
*Ardea alba*

**Black Vulture**  
*Coragyps atratus*

**Wild Turkey**  
*Meleagris gallopavo*

**Barred Owl**  
*Strix varia*

**Chuck-will's-widow**  
*Antrostomus carolinensis*

**Great Crested Flycatcher**  
*Myiarchus crinitus*

**White-eyed Vireo**  
*Vireo griseus*

**Prothonotary Warbler**  
*Protonotaria citrea*

**Northern Parula**  
*Setophaga americana*

**Yellow-throated Warbler**  
*Setophaga dominica*

**American Beaver**  
*Castor canadensis*

**White-tailed Deer**  
*Odocoileus virginianus*

**Washo Reserve  
Charleston Co., SC  
May 29, 2021**

This list was produced by SCAN from sightings produced by SCAN members and is subject to revision as needed. An asterisk (\*) indicates a new sighting for SCAN. Send any changes or corrections to Tom Jones. \_\_\_\_\_

Please indicate exactly to which flora/fauna list you are referring. Thank you.

**LICHENS**

Cryptothecia rubrocincta

**FLORA**

**American Royal Fern**

*Osmunda spectabilis*

**Netted Chain Fern**

*Lorinseria areolata*

**Lizard's-tail**

*Saururus cernuus*

**American Frog's-bit**

*Limnobium spongia*

**Northern White Colic-root**

*Aletris farinosa*

**Southern Blue Flag**

*Iris virginica*

**Pickerelweed**

*Pontederia cordata*

**American Bur-reed**

*Sparganium americanum*

**Narrowleaf Cattail**

*Typha angustifolia*

**Common Cattail**

*Typha latifolia*

**Spanish-moss**

*Tillandsia usneoides*

**Salt-marsh Bulrush**

*Bolboschoenus robustus*

**Bottlebrush Sedge**

*Carex comosa*

**Umbrella Sedge**

*Cyperus virens*

**Witchgrass**

*Dichanthelium* sp.

**Gama Grass**

*Tripsacum dactyloides dactyloides*

**Southern Wild-rice**

*Zizaniopsis miliacea*

**Virginia-willow**

*Itea virginica*

**Tick-trefoil**

*Desmodium paniculatum*

*paniculatum*

**Coral Bean**

*Erythrina herbacea*

**Sesban**

*Sesbania herbacea*

**Pink Milkwort**

*Polygala incarnata*

**Showy Milkwort**

*Asemeia grandiflora*

**Blackberry**

*Rubus* sp.

**New Jersey Tea**

*Ceanothus americanus*

**Walter's Marsh St.-John's-wort**

*Triadenum walteri*

**Yellow Passionflower**

*Passiflora lutea*

**Tread-softly**

*Cnidioscolus stimulosus*

**Water-willow**

*Decodon verticillatus*

**Sundrops**

*Oenothera fruticosa*

**Eastern Poison Ivy**

*Toxicodendron radicans radicans*

**Eastern Rose-mallow**

*Hibiscus moscheutos*

**Swamp Dock**

*Rumex verticillatus*

**Alligator-weed**

*Alternanthera philoxeroides*

**Water Tupelo**

*Nyssa aquatica*

**Three-lobed Bedstraw**

*Galium tinctorium*

**Few-flower Milkweed**

*Asclepias lanceolata*

**Butterfly-weed**

*Asclepias tuberosa*

**Eastern Anglepod**

*Gonolobus suberosus suberosus*

**Coastal Plain Bindweed**

*Convolvulus limnophilus*

**Carolina Horse-nettle**

*Solanum carolinense carolinense*

**Monnier's Water-hyssop**

*Bacopa monnieri*

**Carolina Wild-petunia**

*Ruellia caroliniensis*

**Trumpet-creeper**

*Campsis radicans*

**Beautyberry**

*Callicarpa americana*

**Narrowleaf Skullcap**

*Scutellaria integrifolia*

**Wahlenbergia**

*Wahlenbergia marginata*

**Common Ragweed**

*Ambrosia artemisiifolia*

**Common Yellow Thistle**

*Cirsium horridulum horridulum*

**Longstalk Coreopsis**

*Coreopsis lanceolata*

**Common Cosmos**

*Cosmos bipinnatus*

**Oak-leaved Fleabane**

*Erigeron quercifolius*

**Common Dog-fennel**

*Eupatorium capillifolium*

**Boneset**

*Eupatorium perfoliatum*

**Beach Blanket-flower**

*Gaillardia pulchella drummondii*

**Climbing Hempweed**

*Mikania scandens*

**Blackroot**

*Pterocaulon pycnostachyum*

**Columnar Prairie Coneflower**

\* *Ratibida columnifera*

**Southern Seaside Goldenrod**

*Solidago mexicana*

**Water-hemlock**

*Cicuta maculata maculata*

**Eastern Bishopweed**

*Ptilimnium capillaceum*

**Sanicle**

*Sanicula canadensis*

**FAUNA**

**Square-back Marsh Crab**

*Sesarma cinereum*

**Red-jointed Fiddler Crab**

*Uca minax*

**Sand Fiddler Crab**

*Uca pugilator*

**Long-jawed Orbweaver**

*Tetragnatha* sp.

**Mabel Orchard Orbweaver**

*Leucauge argyroabapta*

**Golden Silk Orbweaver**

*Trichonephila clavipes*

**Six-spotted Fishing Spider**

*Dolomedes triton*

**Daddy-long-legs**

*Leiobunum* sp.

**Brown Stink Bug**

*Euschistus* sp.

**Large Milkweed Bug**

*Oncopeltus fasciatus*

**Spined Assassin Bug**

\* *Sinea diadema*

**Broad-headed Sharpshooter**

\* *Oncometopia orbona*

**Leafhopper**

\* *Tylozygus geometricus*

**Common Eastern Velvet-ant**

*Dasymutilla occidentalis*  
*occidentalis*

**Feather-legged Scoliid Wasp**

*Campsomeris plumipes*

**Noble Scoliid Wasp**

\* *Scolia nobilitata*

**Digger Wasp**

\* *Sphex dorsalis*

**Square-headed Wasp**

\* *Tachytes crassus*

**Sand Wasp**

\* *Bicyrtes quadrifasciatus*

**Horse Guard Wasp**

\* *Stictia carolina*

**Schwarz's Masked Bee**

\* *Hylaeus schwarzii*

**Poey's Furrow Bee**

\* *Halictus poeyi*

**Leaf-cutting Bee**

*Megachile* sp.

**Eastern Carpenter Bee**

*Xylocopa virginica*

**Bumblebee**

*Bombus impatiens*

**Brown-belted Bumblebee**

*Bombus griseocollis*

**Honey Bee**

*Apis mellifera*

**Lovebug**

*Plecia nearctica*

**White-faced Plushback**

\* *Palpada albifrons*

**Stilt-legged Fly**

\* *Taeniptera* sp.

**Swift River Cruiser**

*Macromia illinoiensis illinoiensis*

**Eastern Pondhawk**

*Erythemis simplicicollis*

**Needham's Skimmer**

*Libellula needhami*

**Great Blue Skimmer**

*Libellula vibrans*

**Blue Dasher**

*Pachydiplax longipennis*

**Rambur's Forktail**

*Ischnura ramburi*

**Green Foliage Ground Beetle**

*Lebia viridis*

**Flower Scarab Beetle**

*Trigonopeltastes delta*

**Metallic Wood-boring Beetle**

\* *Buprestis maculipennis*

**Firefly; Lightning Beetle**

*Photinus pyralis*

**Twice-stabbed Lady Beetle**

*Chilocorus stigma*

**Multicolored Asian Lady Beetle**

*Harmonia axyridis*

**Black Swallowtail**

*Papilio polyxenes*

**Red-banded Hairstreak**

*Calycopis cecrops*

**Pearl Crescent**

*Phyciodes tharos*

**Common Buckeye**

*Junonia coenia*

**Carolina Satyr**

*Hermeuptychia sosybius*

**Appalachian Brown**

*Lethe appalachia*

**Silver-spotted Skipper**

*Epargyreus clarus*

**Horace's Duskywing**

*Erynnis horatius*

**Clouded Skipper**

*Lerema accius*

**Fiery Skipper**

*Hylephila phyleus*

**Broad-winged Skipper**

*Poanes viator*

**Brazilian Skipper**

*Calpodus ethlius*

**Salt Marsh Skipper**

*Panoquina panoquin*

**Angle Moth**

*Macaria* sp.

**Common Eupithecia Moth**

\* *Eupithecia miserulata*

**Giant Leopard Moth**

*Hypercompe scribonia*

**Southern Toad**

*Anaxyrus terrestris*

**Green Treefrog**

*Hyla cinerea*

**Green Frog**

*Lithobates clamitans*

**Southern Leopard Frog**

*Lithobates sphenoccephala*  
*utricularia*

**American Alligator**

*Alligator mississippiensis*

**Eastern Mud Turtle**

*Kinosternon subrubrum*

**Green Anole**

*Anolis carolinensis*

**Eastern Ratsnake**

*Pantherophis alleghaniensis*

**Cottonmouth**

*Agkistrodon piscivorus*

**Brown Pelican**

*Pelecanus occidentalis*

**Anhinga**

*Anhinga anhinga*

**Double-crested Cormorant**

*Phalacrocorax auritus*

**Least Bittern**

*Ixobrychus exilis*

**Tricolored Heron**

*Egretta tricolor*

**Little Blue Heron**

*Egretta caerulea*

**Snowy Egret**

*Egretta thula*

**Great Blue Heron**

*Ardea herodias*

**Great Egret**

*Ardea alba*

**Wood Stork**

*Mycteria americana*

**Glossy Ibis**

*Plegadis falcinellus*

**Common Gallinule**

*Gallinula galeata*

**Black-necked Stilt**

*Himantopus mexicanus*

**Killdeer**

*Charadrius vociferus*

**Laughing Gull**

*Leucophaeus atricilla*

**Gull-billed Tern**

*Gelochelidon nilotica*

**Forster's Tern**

*Sterna forsteri*

**Osprey**

*Pandion haliaetus*

**Mourning Dove**

*Zenaida macroura*

**Common Nighthawk**

*Chordeiles minor*

**Chimney Swift**

*Chaetura pelagica*

**Red-bellied Woodpecker**

*Melanerpes carolinus*

**Red-headed Woodpecker**

*Melanerpes erythrocephalus*

**Downy Woodpecker**

*Dryobates pubescens*

**Eastern Kingbird**

*Tyrannus tyrannus*

**Great Crested Flycatcher**

*Myiarchus crinitus*

**Eastern Wood-pewee**

*Contopus virens*

**Tree Swallow**

*Tachycineta bicolor*

**Purple Martin**

*Progne subis*

**Barn Swallow**

*Hirundo rustica*

**Blue Jay**

*Cyanocitta cristata*

**Tufted Titmouse**

*Baeolophus bicolor*

**Carolina Chickadee**

*Poecile carolinensis*

**Brown-headed Nuthatch**

*Sitta pusilla*

**Carolina Wren**

*Thryothorus ludovicianus*

**Marsh Wren**

*Cistothorus palustris*

**Blue-gray Gnatcatcher**

*Poliptila caerulea*

**Eastern Bluebird**

*Sialia sialis*

**Northern Mockingbird**

*Mimus polyglottos*

**Brown Thrasher**

*Toxostoma rufum*

**White-eyed Vireo**

*Vireo griseus*

**Yellow-throated Vireo**

*Vireo flavifrons*

**Prothonotary Warbler**

*Protonotaria citrea*

**Northern Parula**

*Setophaga americana*

**Yellow-throated Warbler**

*Setophaga dominica*

**Pine Warbler**

*Setophaga pinus*

**Northern Cardinal**

*Cardinalis cardinalis*

**Painted Bunting**

*Passerina ciris*

**Chipping Sparrow**

*Spizella passerina*

**Red-winged Blackbird**

*Agelaius phoeniceus*

**Brown-headed Cowbird**

*Molothrus ater*

**Common Grackle**

*Quiscalus quiscula*

**Boat-tailed Grackle**

*Quiscalus major*

**Orchard Oriole**

*Icterus spurius*

**Summer Tanager**

*Piranga rubra*

**Hispid Cotton Rat**

*Sigmodon hispidus*